

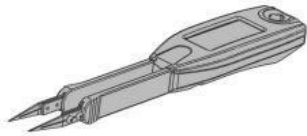

# Smart Tweezers LCR-meter Technique

This is a simple guide to setting up Smart...

Written By: brittany



# INTRODUCTION

This is a simple guide to setting up Smart Tweezers to measure Small Capacitance and Resistance.

If measuring for Resistance, select Resistance mode from the menu instead of Capacitance.

---

## TOOLS:

[Smart Tweezers](#) (1)

---

### Step 1 — Smart Tweezers LCR-meter Technique



- First, turn on the Smart [Tweezers](#) device by pressing the navigation button

## Step 2

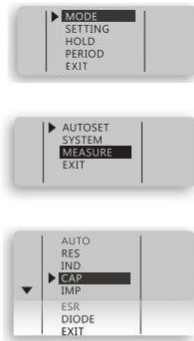

- Small capacitance is best measured in 'Manual Mode' with 10 KHz testing frequency.
- To Switch to 'Manual Mode', hold the navigation button down until the menu appears. Select and press MODE. Then MEASURE. Then select CAP.
- The device is now in Capacitance Mode.

## Step 3

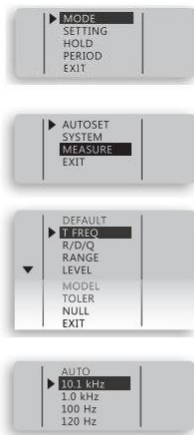

- Now the Test Frequency needs to be changed to 10KHz.
- Press the Navigation button again, and select MEASURE. Then SETTING, then T.FREQ. Select 10KHz.
- The number on the screen that appears is the capacitance between the two tweezer tips at their default distance. This is the Capacitance Offset.
- The offset is varied by the distance between the tips. The smaller the component, the closer the tips are together, thus a higher offset evaluation.

## Step 4

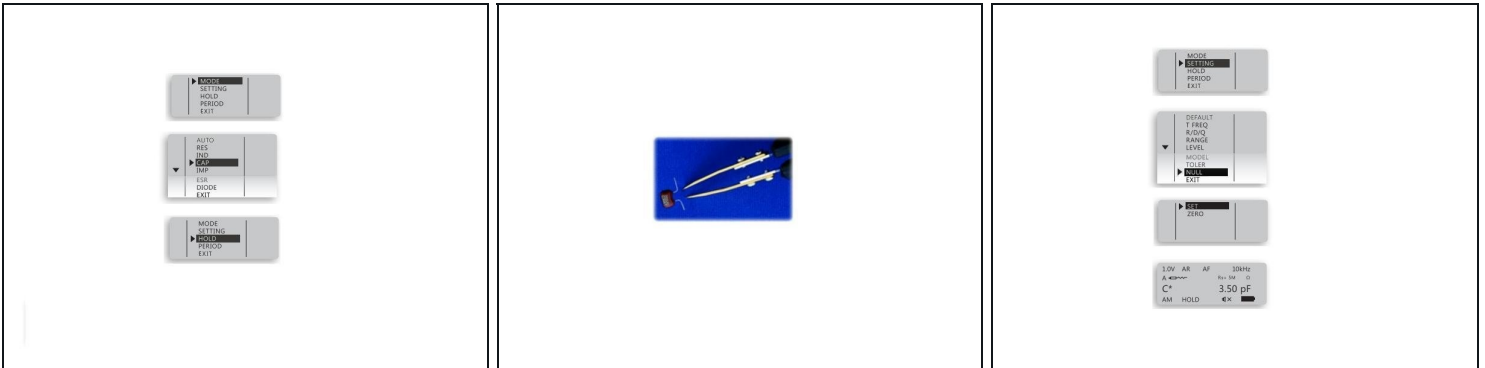

- To store the offset so Smart Tweezers can automatically deduce it from measurements, first, enter the menu, select MODE, and set the device to manual CAP measurement.
- Then select HOLD
- Set the tweezer tips apart to a distance equal to the component to be measured. This is the offset.
- Enter the NULL menu, and select SET.
- An asterisk will appear beside the test mode indicator while measuring to indicate an offset has been stored.

## Step 5

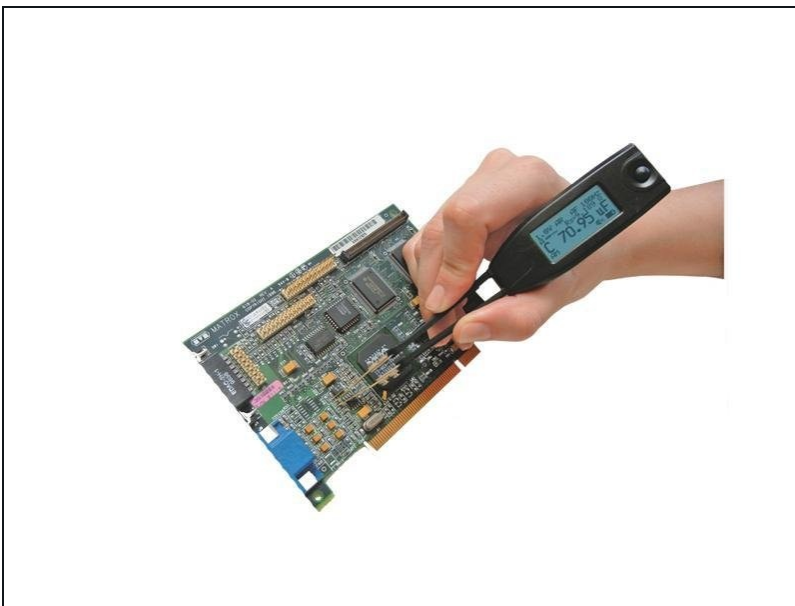

- Now that an offset has been stored, Capacitance can be measured more accurately.

## Step 6



- When you are finished measuring, make sure to reset the offset and custom settings by selecting the menu, then pressing AUTOSET.

---

To turn off custom settings, frequencies, and erase the offset, hold the navigation button, and press AUTOSET.