

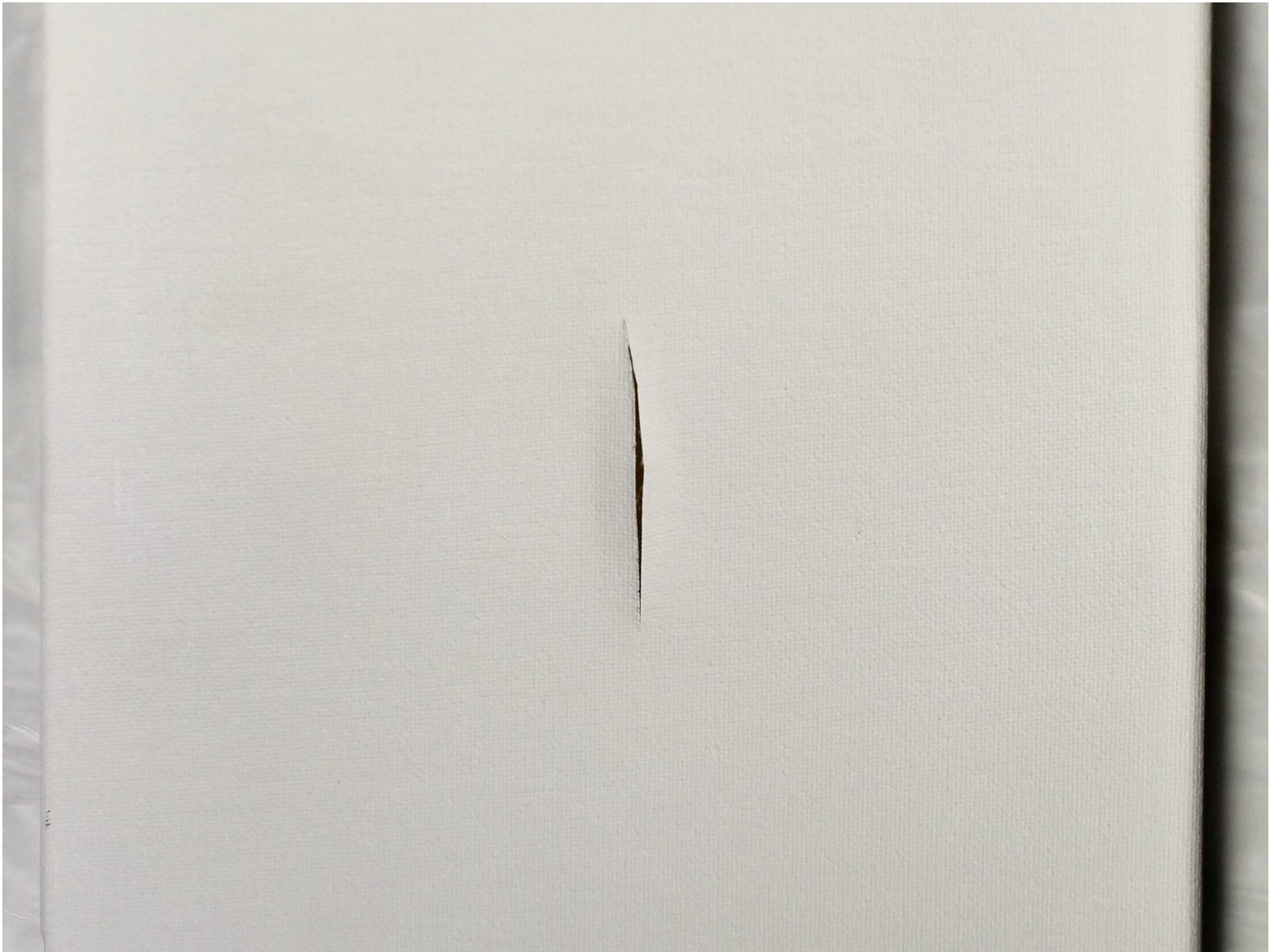

How to Repair a Torn Canvas

This guide will show you how to fix a torn canvas using an unprimed canvas and gesso acrylic.

Written By: Hazel Sanchez



INTRODUCTION

If your valuable canvas painting has been torn apart, this guide will show step by step on how to repair a torn canvas using simple tools in less time.

This guide is based on the stretched canvas. This canvas in particular is used for acrylic painting. It is made from cotton, specifically used for tools such as gesso acrylic paint which creates an ideal surface for painting. Reusing old canvases or saving prized ones can reduce once's budget. Most canvas paintings come in different shapes, sizes, and types. Canvas boards are reusable so there's no need to throw unwanted canvas away. Despite being torn, it can be easily repaired and used for craft purposes or paintings.

The secret to repairing a tear in the canvas is by flipping the front side to the back. Following the steps chronologically and away from any dust or dirt can increase the chances of completing this guide successfully.

TOOLS:

- [Utility Scissors](#) (1)
 - [Scotch tape](#) (1)
 - [Small Paintbrush](#) (1)
 - [Gesso acrylic paint](#) (1)
 - [Unprimed canvas](#) (1)
 - [Clear trash bag](#) (1)
-

Step 1 — How to Repair a Torn Canvas



- Prepare a workstation by taping down a clear trash bag on a flat surface.

Step 2

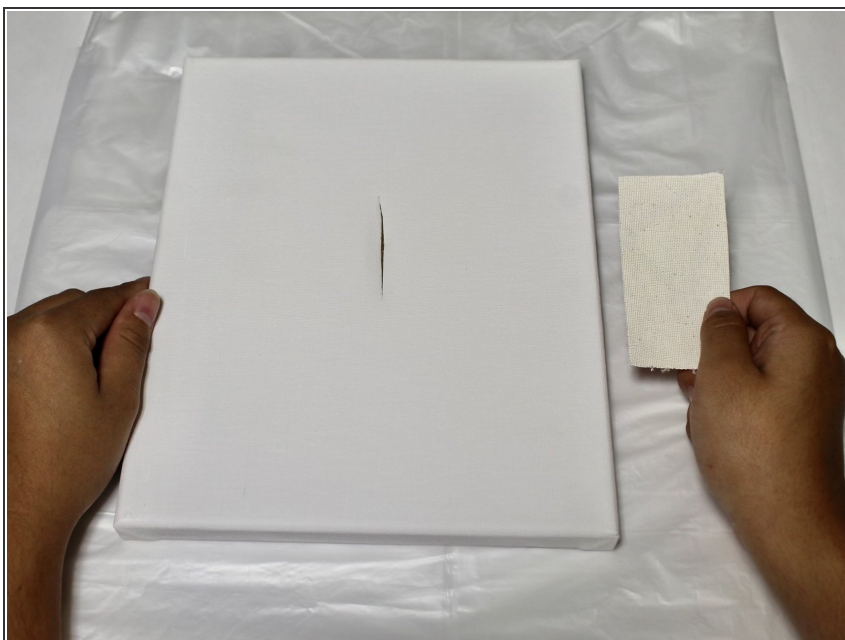

- Using a pair of scissors, cut a piece of unprimed canvas large enough to cover the tear.

Step 3

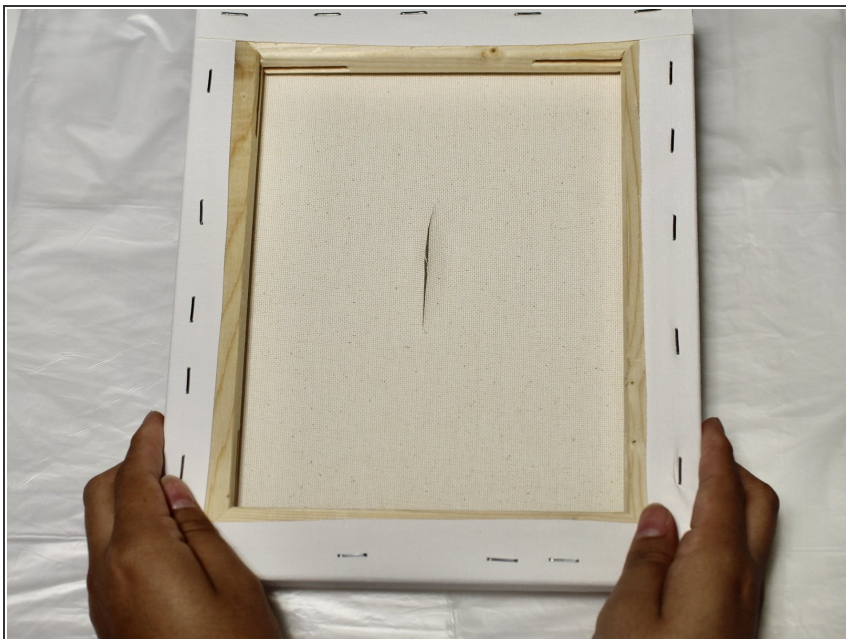

- The front side of the torn canvas needs to be facing down to apply the first coat of gesso acrylic paint.

Step 4



- Apply gesso acrylic paint to one side of the scrap.

Step 5

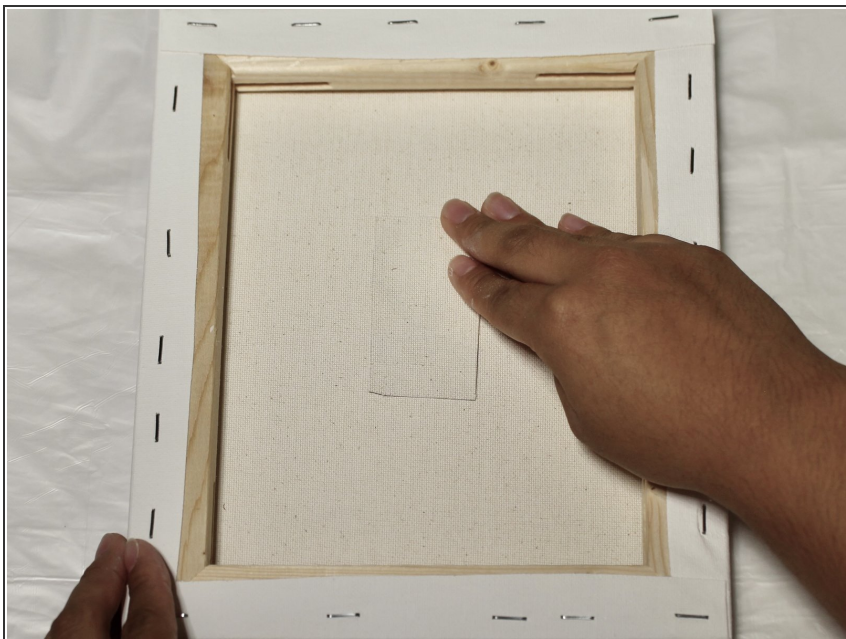

- Place the scrap on top of the tear and smooth it out as much as possible.

Step 6

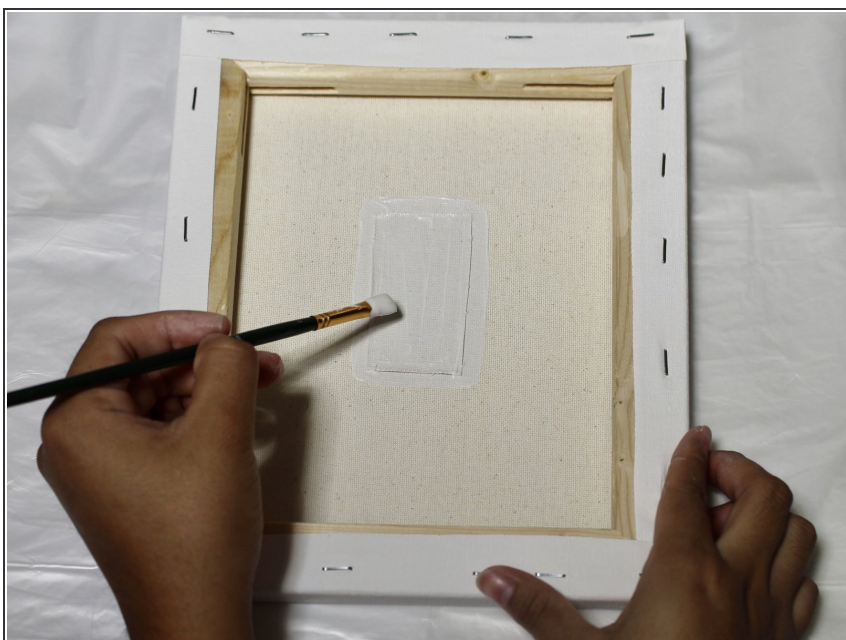

- Add more gesso acrylic paint on top to seal in the sides.

Step 7



- Once it's dry, flip the torn canvas to the front side and seal in with approximately two coats of gesso acrylic paint to cover the tear completely.

To reassemble your device, follow these instructions in reverse order.