



Newport e500 Power Supply Disassembly

This guide deals with the disassembly of the power supply in the Newport e500 ventilator.

Written By: Jared McMullen

Power Supply

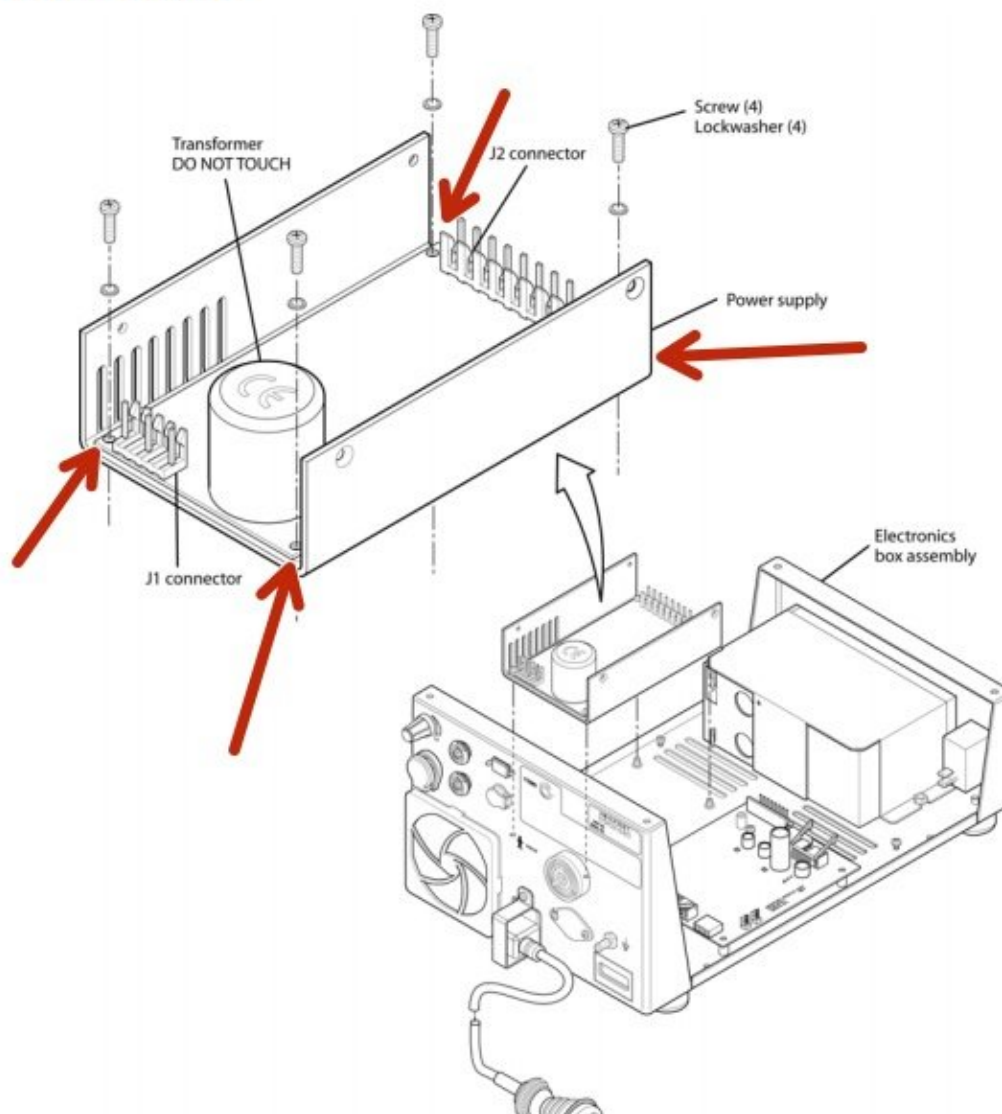

INTRODUCTION

This step of removing the power supply needs to be done carefully. It is important to note that in no instance are you able to touch the transformer on the power supply. This could lead to permanent damage. For more information go to page 75 of the service manual.

TOOLS:

- [Phillips #0 Screwdriver](#) (1)
-

Step 1 — Newport e500 Top Cover Disassembly

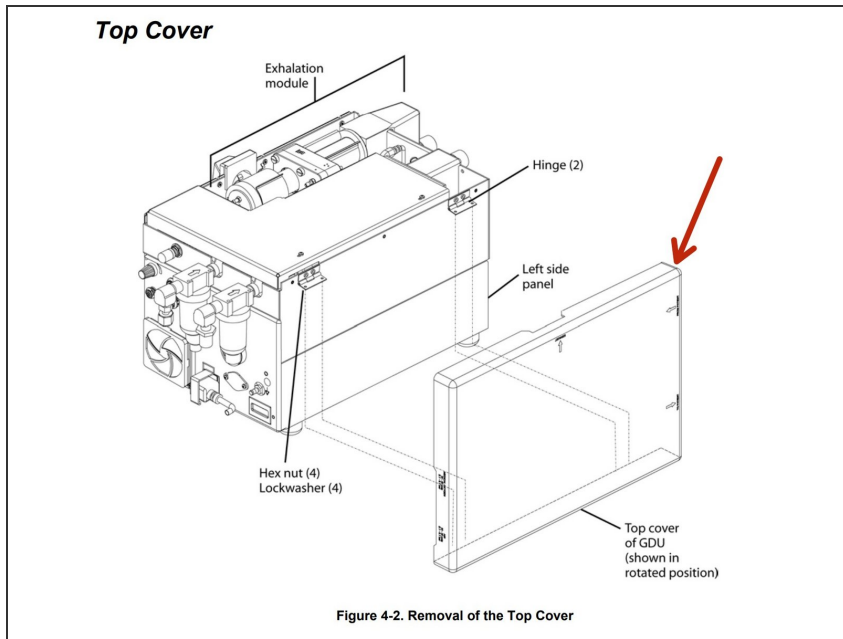

- Place device so that the top cover is facing you.
- Open the top cover.

Step 2

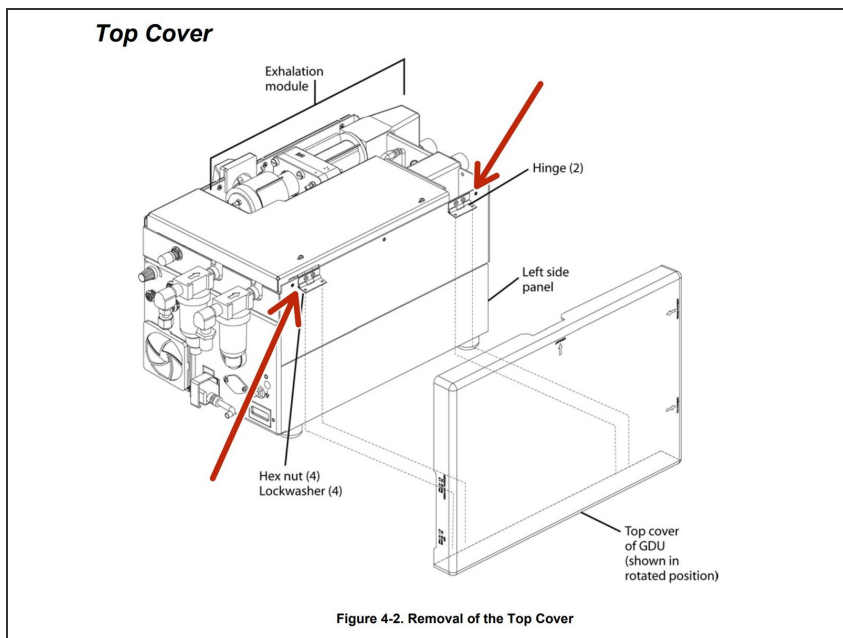

- Remove the four hex nuts and lock washers (two at each hinge) that secure the cover to the hinges on the left side of the pneumatic box.

Step 3

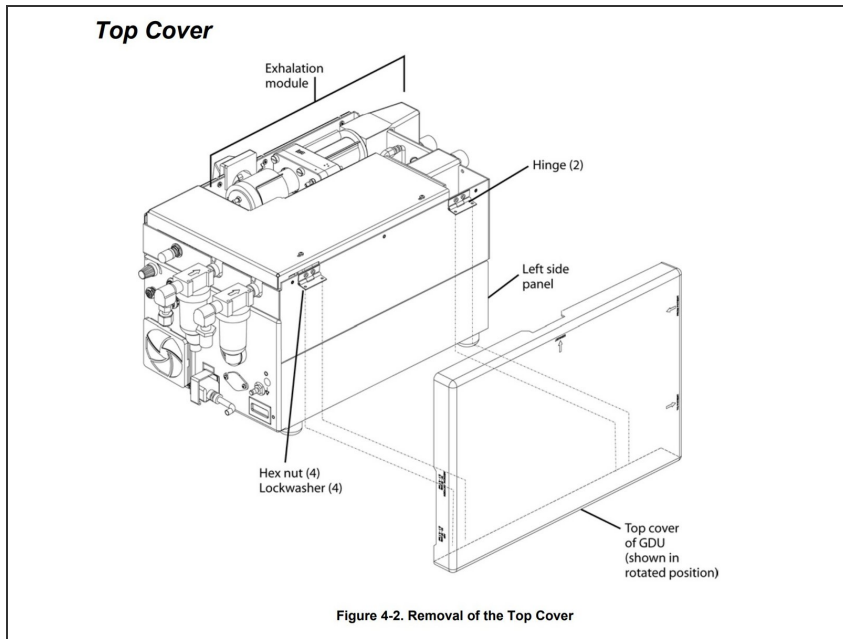

- Remove the cover and set aside. Retain hardware for re-assembly.

Step 4 — Newport e500 Left Side Panel Disassembly

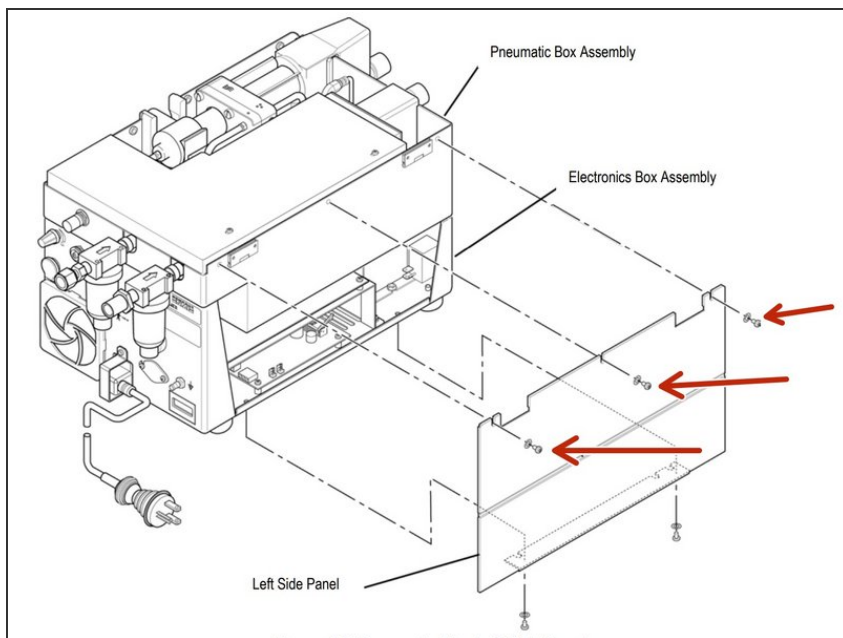

- Carefully place the GDU on its right side with the front of the GDU facing you.
- Remove the three screws and washers at the top edge of the left side panel.

Step 5

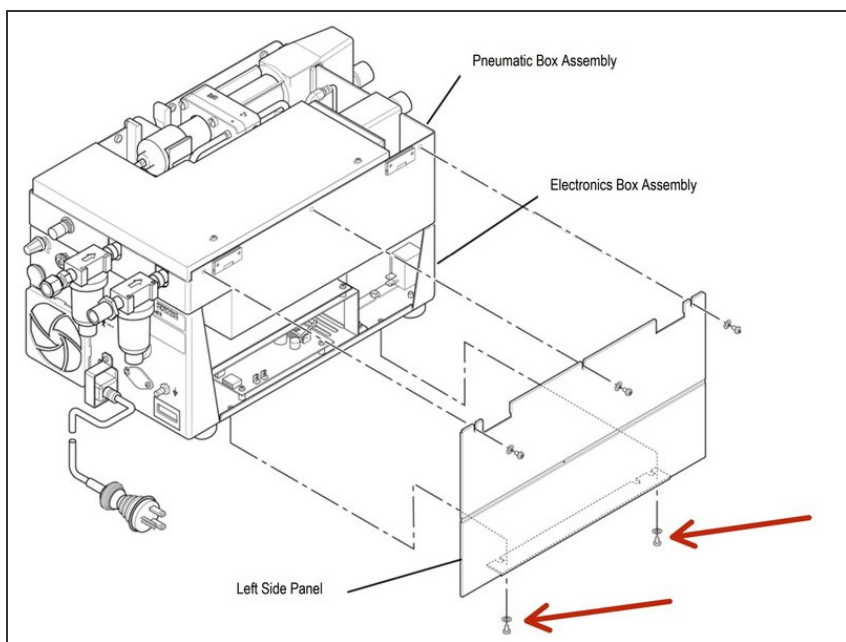

- Remove the two screws and washers from the underside of the left side panel.

Step 6

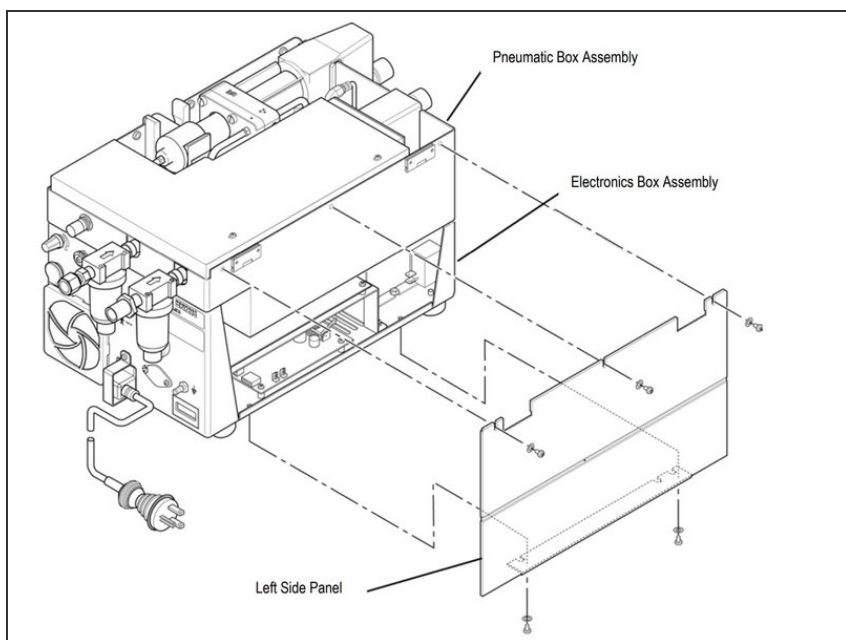

- Remove the left side panel. Retain hardware for re-assembly.

Step 7 — Newport e500 Right Side Panel Disassembly

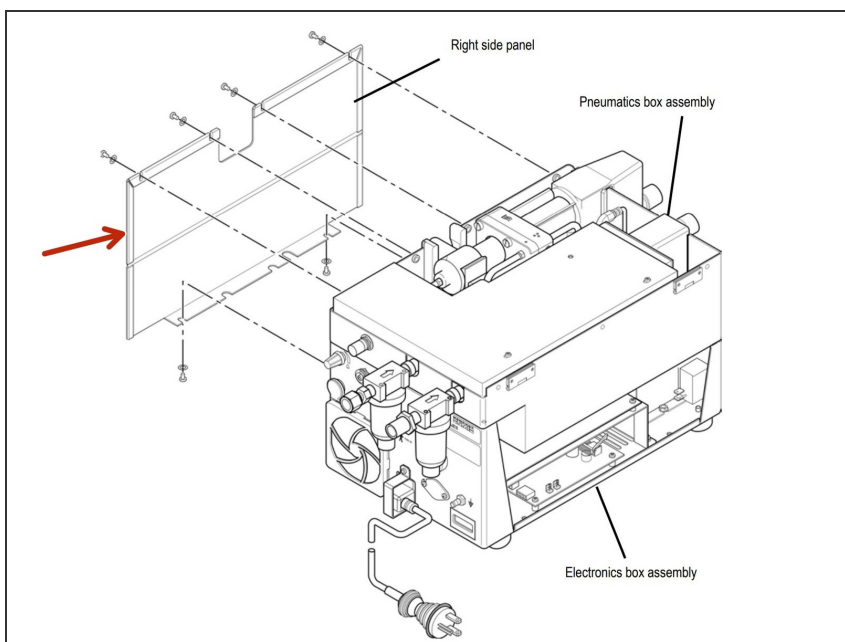

- Carefully place the GDU on its left side.

Step 8

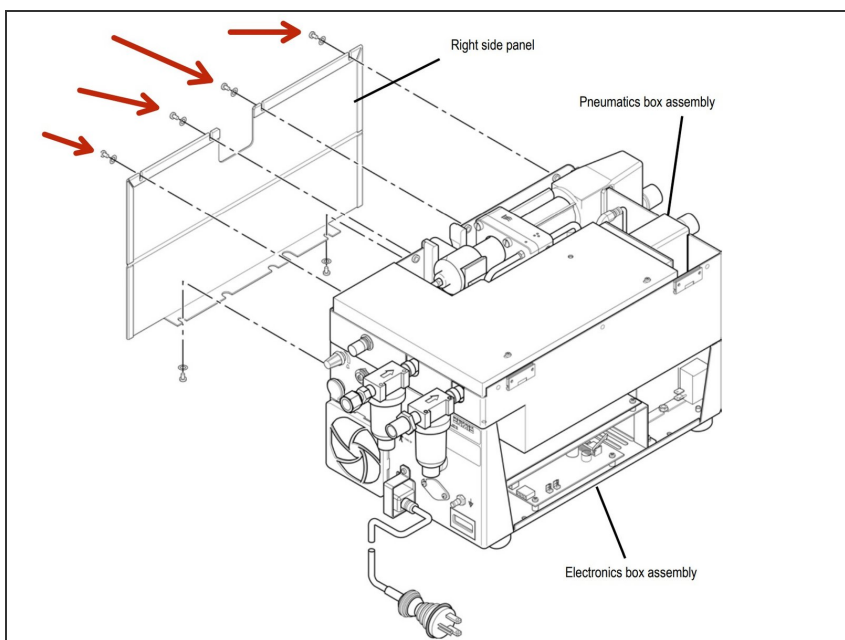

- Remove the four screws and washers at the top edge of the right side panel.

Step 9

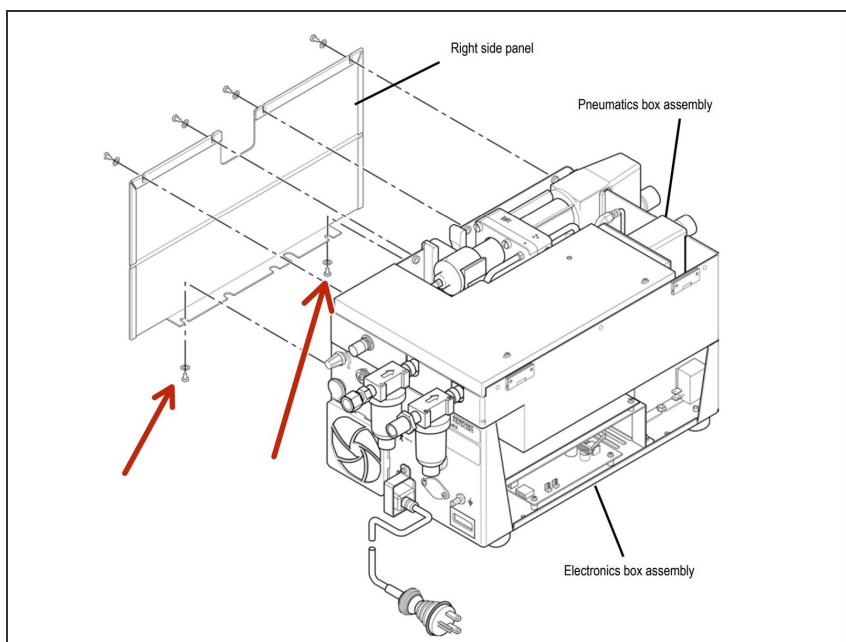

- Remove the two screws and washers from the underside of the right side panel.

Step 10

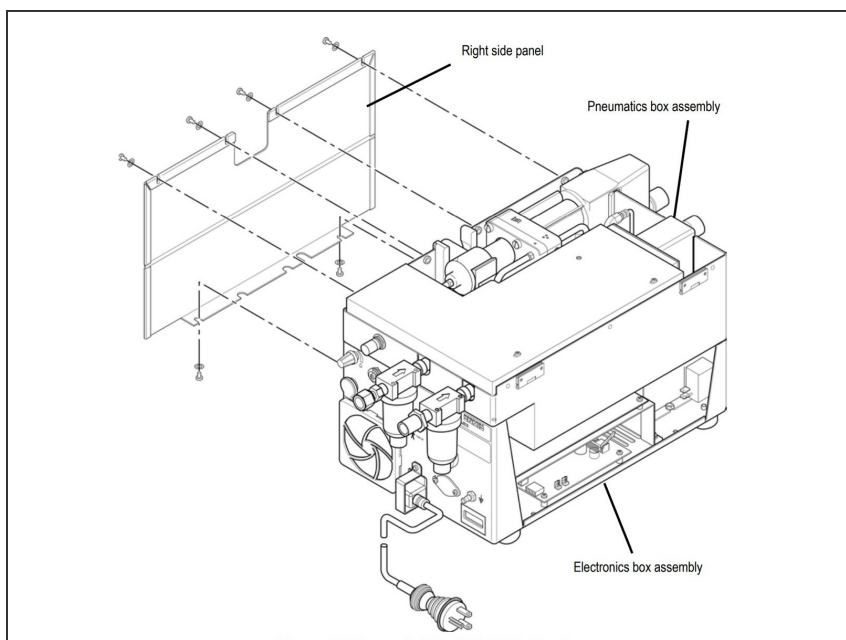

- Remove the right side panel. Retain hardware for re-assembly.

Step 11 — Newport e500 Flow Sensor Cover Disassembly

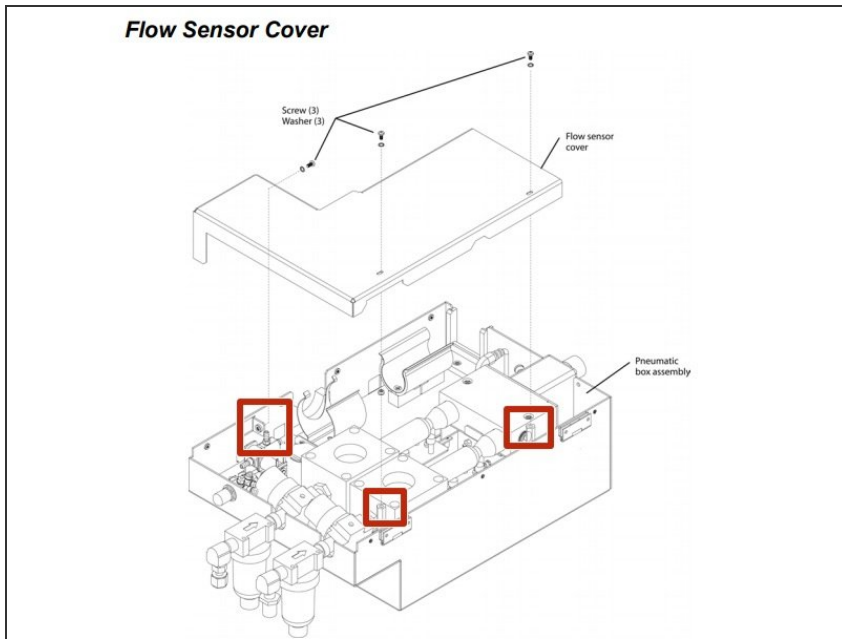

- Remove the three screws and washers that secure the flow sensor cover to the pneumatic box assembly. Retain the hardware for re-assembly.

Step 12

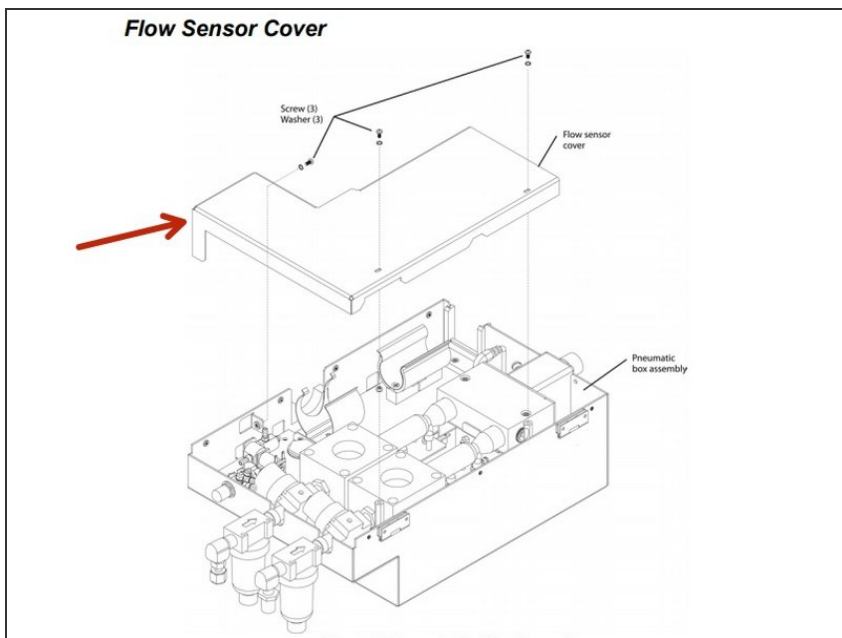

- Remove the flow sensor cover.

Step 13 — Newport e500 Pneumatic Box Disassembly

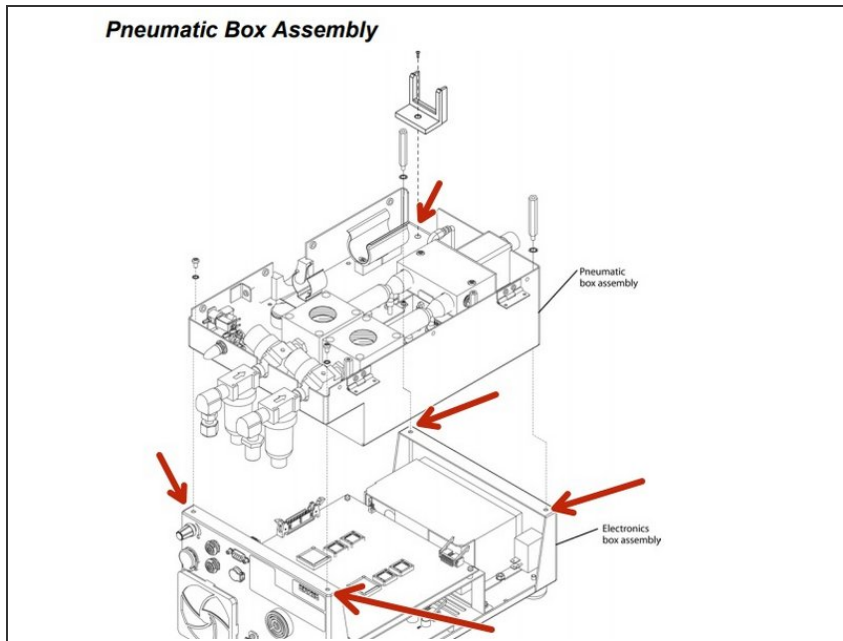

- Remove the two screws and washers (back corners), one screw and washer (exhalation module support bracket), and two standoffs and washers (front corners) that secure the pneumatic (upper) box assembly to the electronic box assembly. Lift the Pneumatics Box and carefully tilt to one side.

Step 14

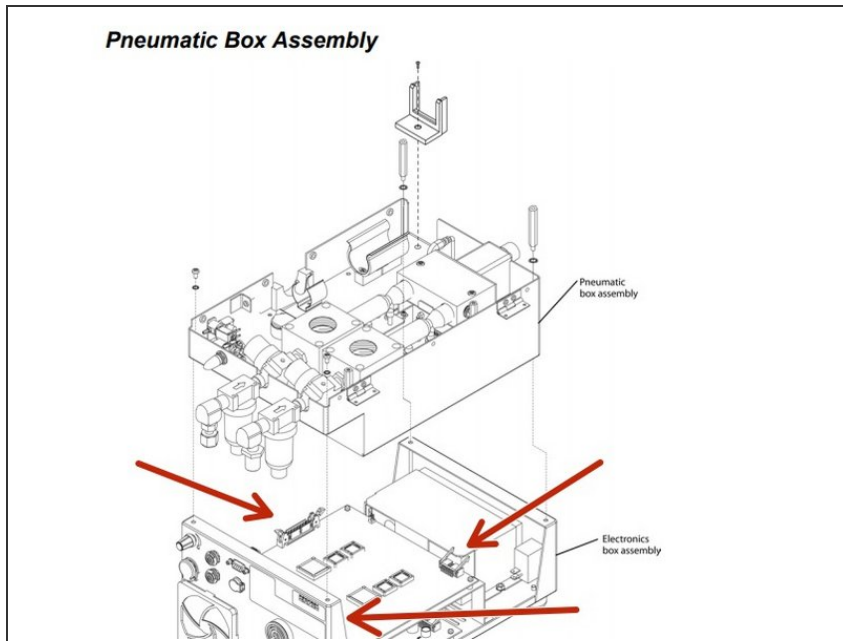

- Remove cables from connectors J1, J2, J3, J4, J5, and J6 on the main PCB (4 connectors are not shown due to being blocked by the side panel). Note the position of these connectors for re-assembly.

Step 15

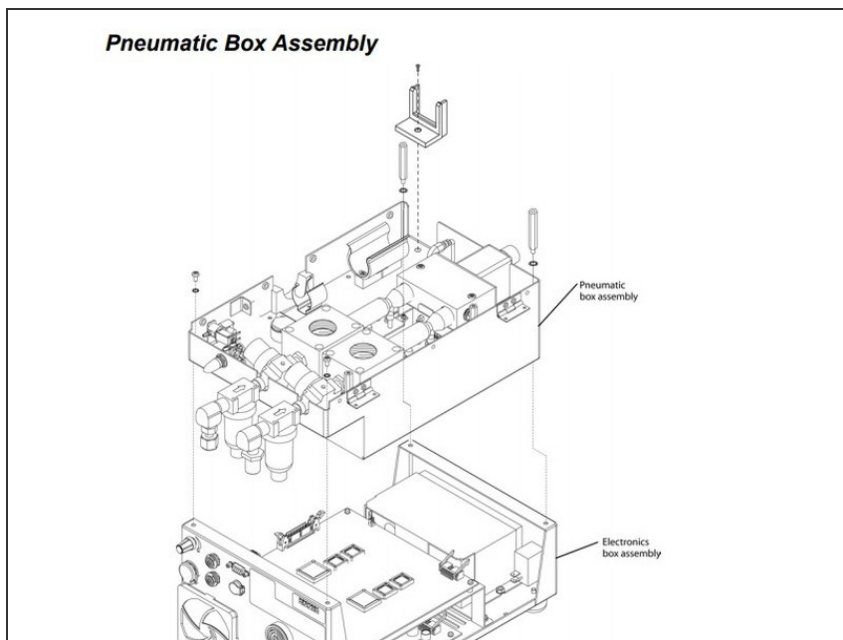

- If not already detached, remove the heater cables from J5 and J6 on the DC-DC power supply PCB.

Step 16 — Newport e500 Power Supply Disassembly

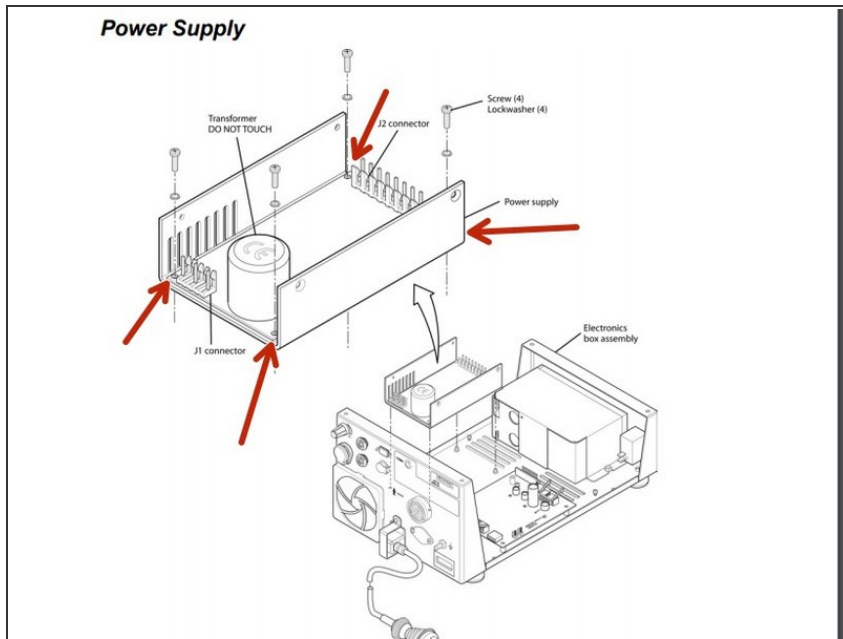

- From the underside of the electronics box assembly, remove the four screws and lock washers that secure the power supply to the box assembly.

Step 17

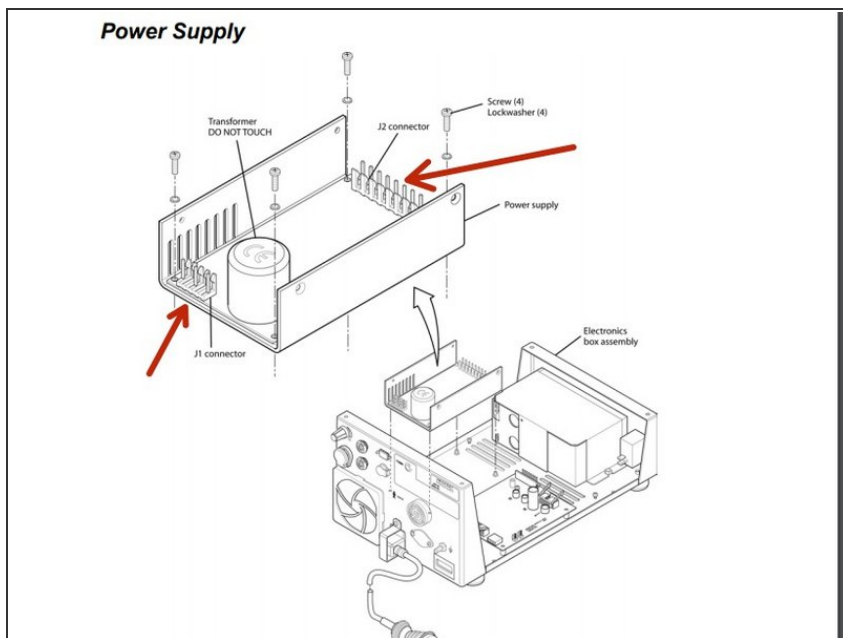

- Disconnect cables from connectors J1 and J2 on the power supply.

Step 18

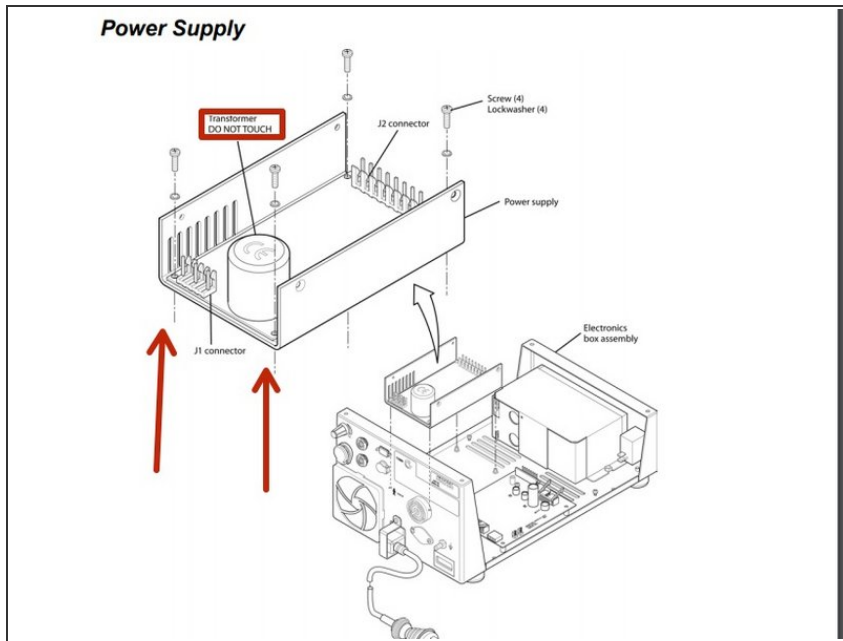

- Lift the power supply out of the electronics box assembly.

To reassemble your device, follow these instructions in reverse order.