



Newport e500 Left Side Panel Disassembly

This guide will show you how to remove the left side panel on the Newport e500 ventilator.

Written By: Jeremy

Left Side Panel

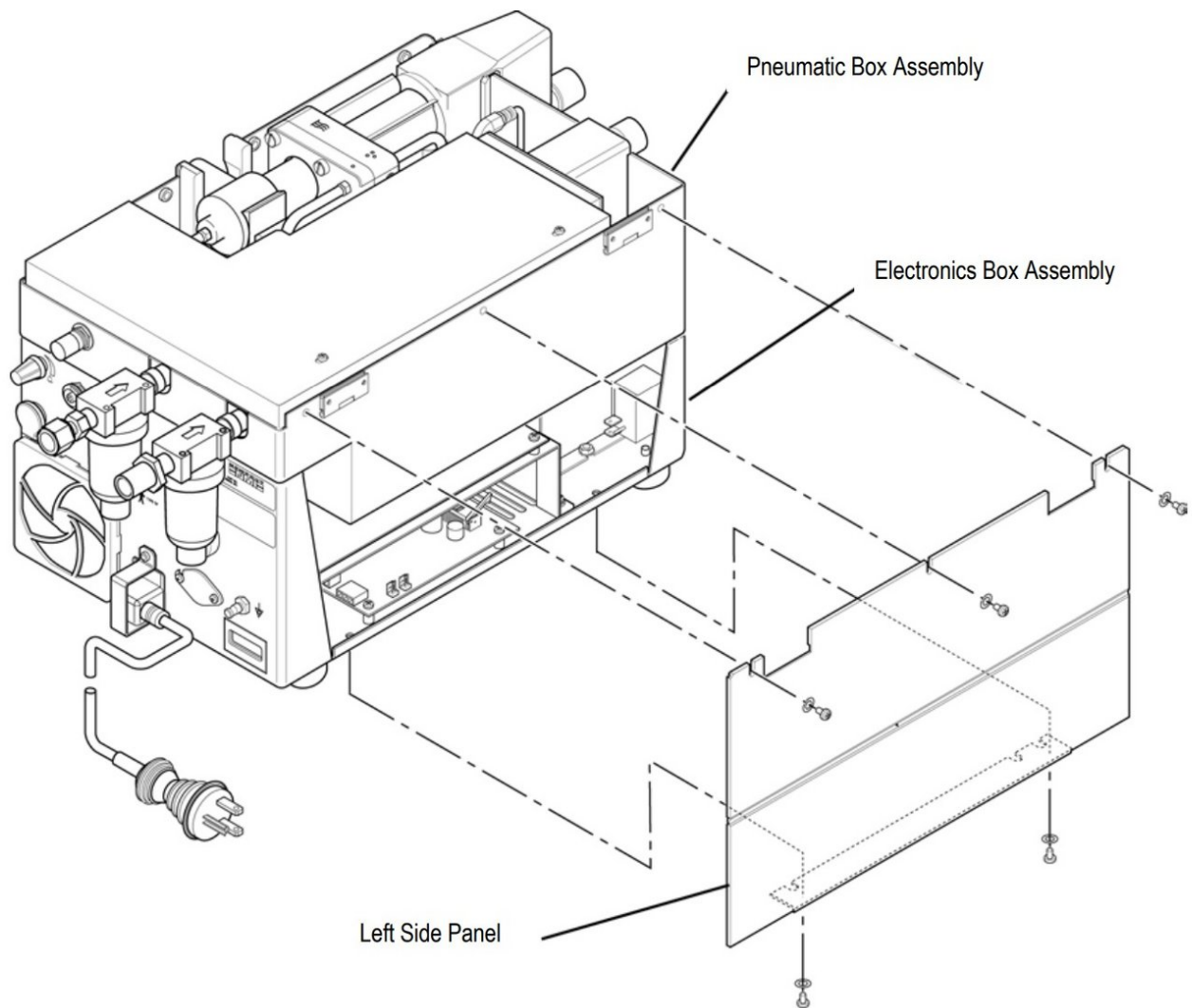

INTRODUCTION

This guide covers how to remove the left side panel of the Newport e500 to gain access to other components to perform repairs/replacements. A Philips screwdriver will be necessary to perform this operation. When re-installing the left side panel, fold the hinges up so that the reinstalled panel does not cover the hinges. For more information refer to page 40 of the service manual.



TOOLS:

- [Phillips #0 Screwdriver](#) (1)
-

Step 1 — Newport e500 Left Side Panel Disassembly

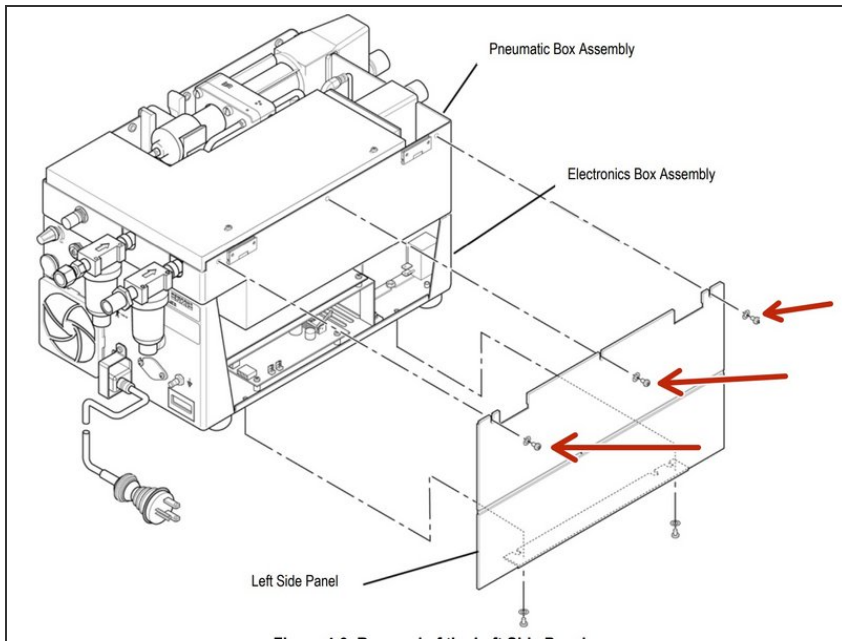

- Carefully place the GDU on its right side with the front of the GDU facing you.
- Remove the three screws and washers at the top edge of the left side panel.

Step 2

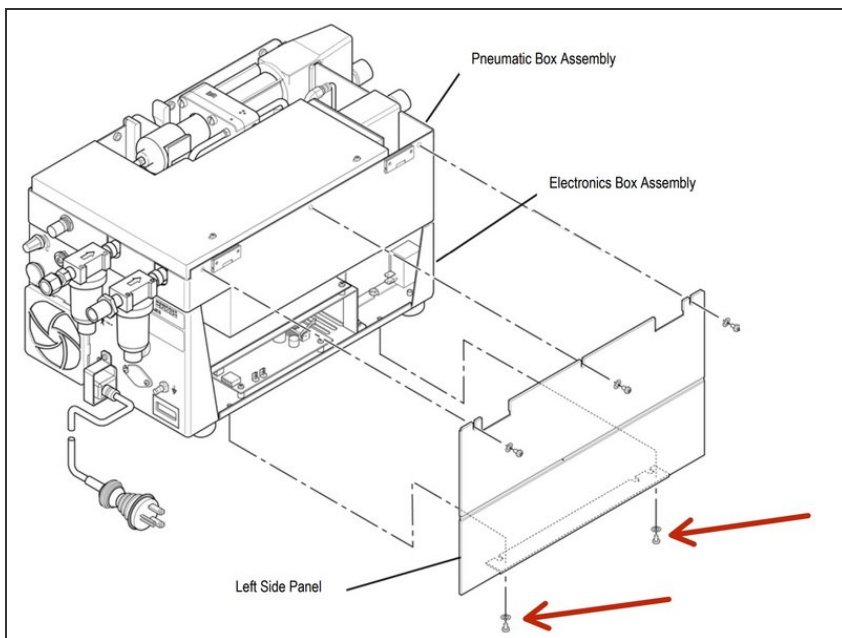

- Remove the two screws and washers from the underside of the left side panel.

Step 3

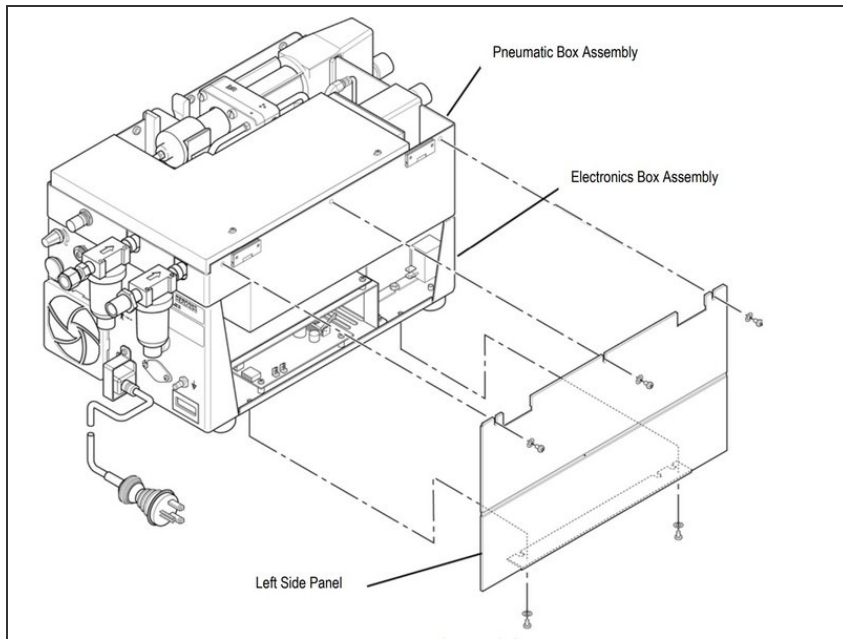

- Remove the left side panel. Retain hardware for re-assembly.

To reassemble your device, follow these instructions in reverse order.