



Newport e500 Exhalation Module Disassembly

This guide will show you how to remove the exhalation module in the Newport e500 ventilator.

Written By: Jared McMullen

Exhalation Module

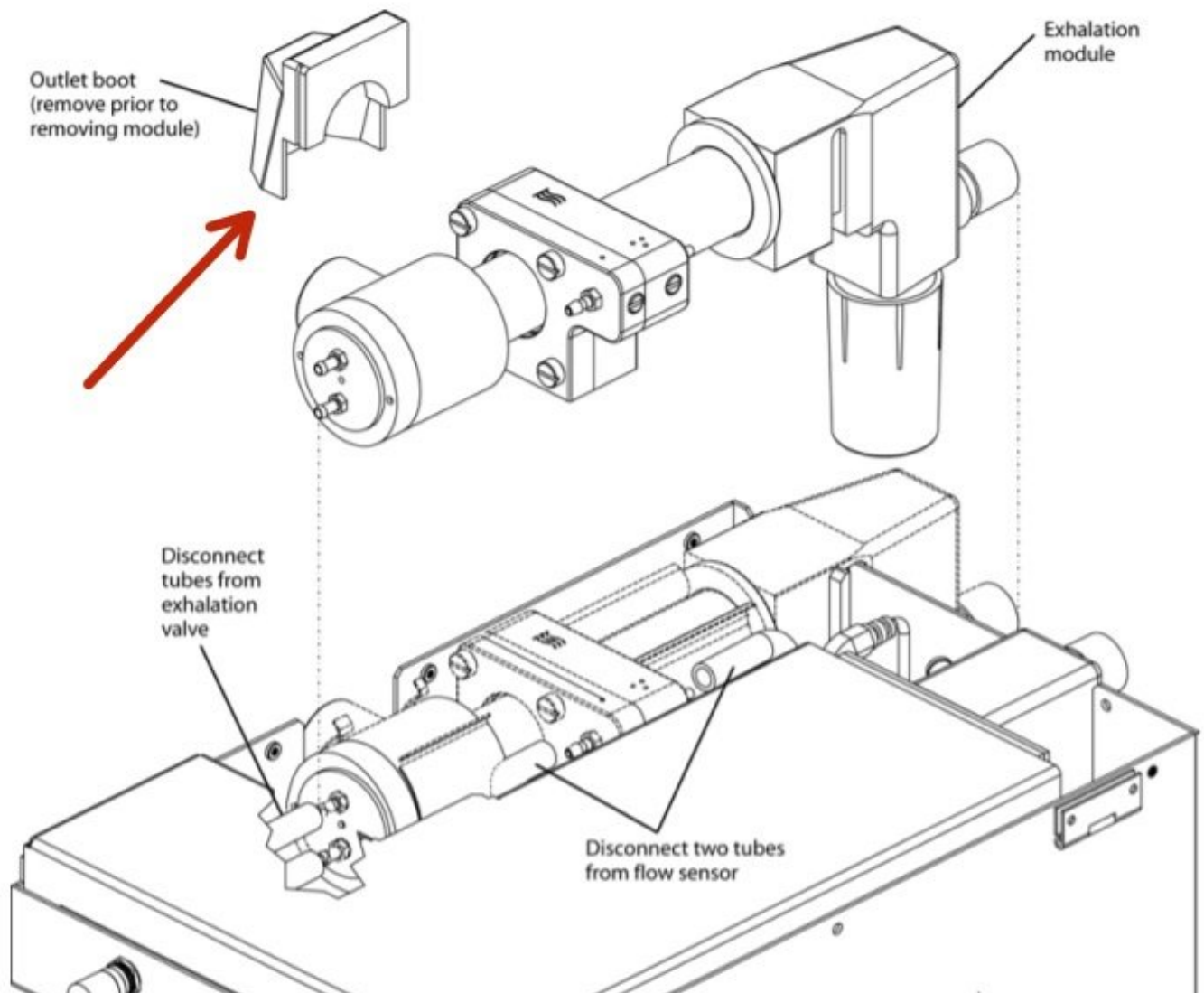

INTRODUCTION

If you need to access important parts associated with the Newort e500, removal of the exhalation module is an integral step. This step serves as a common pre-requisite to completing other guides. Make sure you are careful with the outlet boot as it is fragile. For more information refer to page 42 of the service manual.

Step 1 — Newport e500 Exhalation Module Disassembly

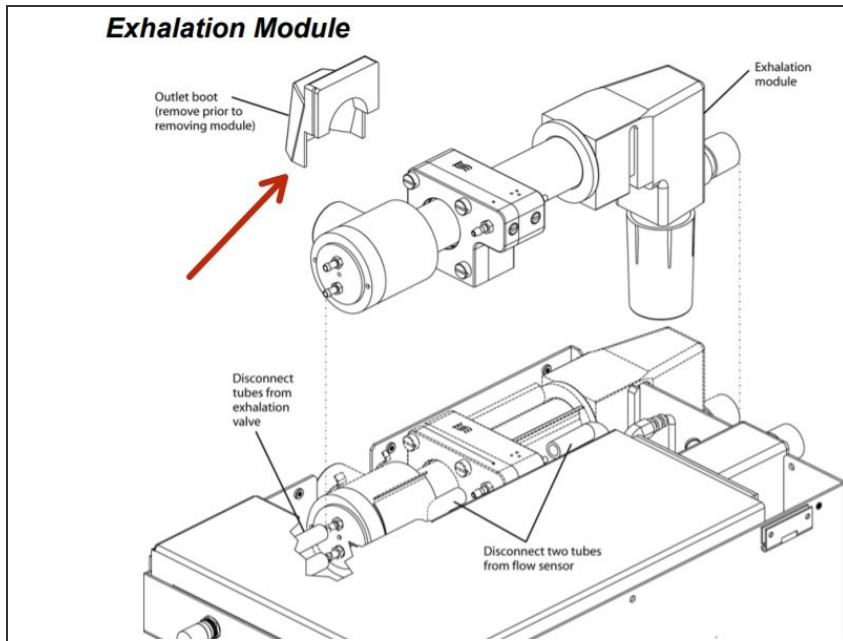

- Pull up and remove the flexible rubber exhalation outlet boot (push fit).

Step 2

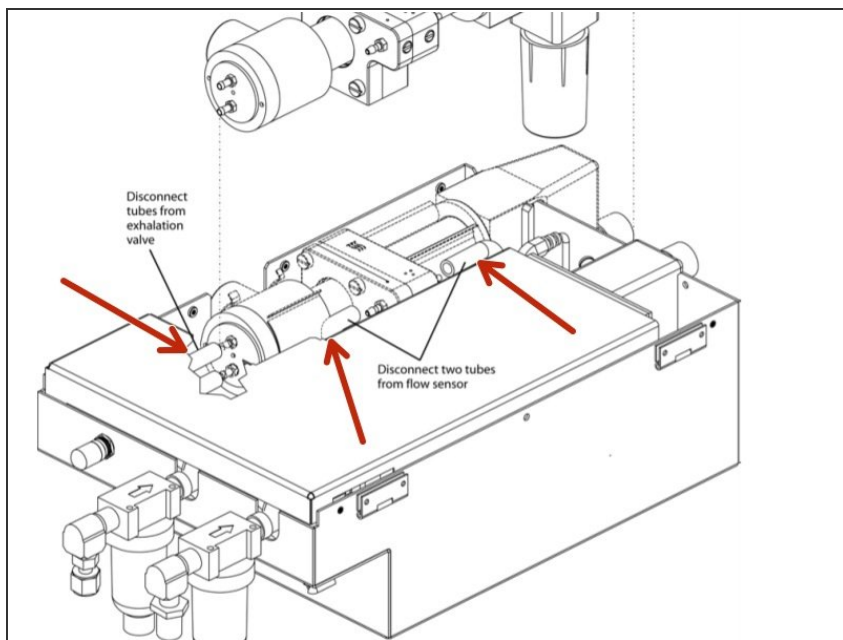

- Disconnect the tubes from both sides of the flow sensor and the two tubes from the exhalation valve.

Step 3

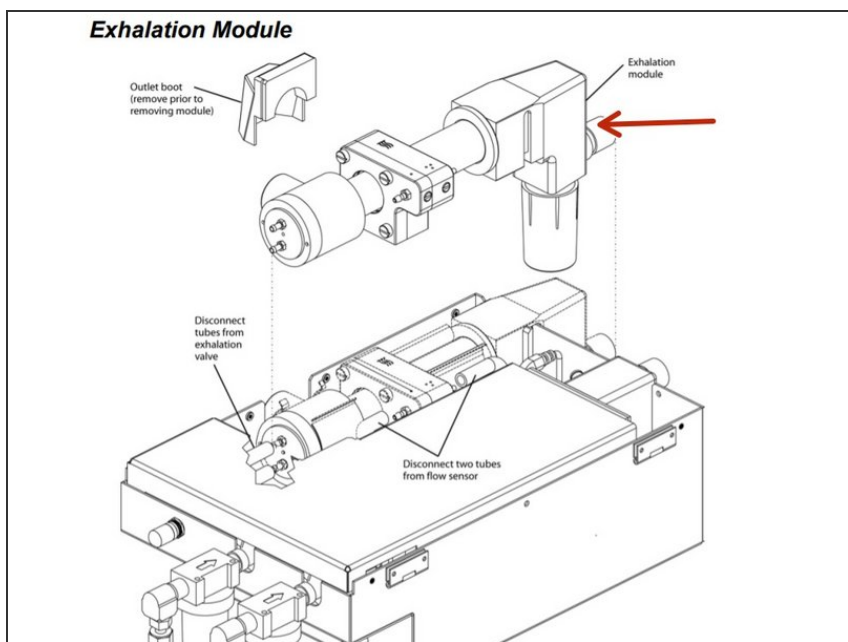

- Pull the exhalation module straight up to remove it from the GDU.

To reassemble your device, follow these instructions in reverse order.